



Finishes You've Never Seen Before®

COPPER

CORTEN FASCIA, SOFFIT,
AND WALL PANELS

WESTERN REVEAL® FLUSH REVEAL PANEL - 12" FACE SIZE

For Metal Wall Panels, Fascia, Soffit, and Ceiling Panels

Available Materials: Aluminum, Copper, Corten/A606-4, Steel

Available Finishes: Bare Steel, Galvalume®/Zincalume®, Galvanized, PVDF, SMP Painted

SPECIFICATIONS:

Profile Type:	Western Reveal®	Coil Feed:	36", 24", 20"
Face Size:	12"	Panel Length:	1' to 35' max
Available Reveals:	<ul style="list-style-type: none"> • NR - No Reveal • 1.0 - 1" Reveal • 2.0 - 2" Reveal • 3.0 - 3" Reveal 	Substrate:	Copper
		Finish:	Copper
Available Gauges:	16 oz, 20 oz	Warranty:	Sold AS IS – No Warranty
Fastening Type:	Concealed	Stiffening Ribs or Pencil Ribs:	Available Upon Request
Rib Height:	1.5"	Single or Double Vent Strips:	Available Upon Request
Overall Coverage:	13"-19"	Installation:	Installed Over A Solid Substrate (Vertical or Horizontal)

Mix and match different reveals, face sizes, and widths.

APPLIES TO THE FOLLOWING COLORS/FINISHES:

- Copper

***Material does not arrive pre-weathered. Copper panels will develop a natural patina over time with exposure to the elements. Use stainless steel screws for installation. Please refer to Copper dissimilar metals and product handling disclaimer for more information.



Shown in Copper, Reveal 1.0

PROFILE:

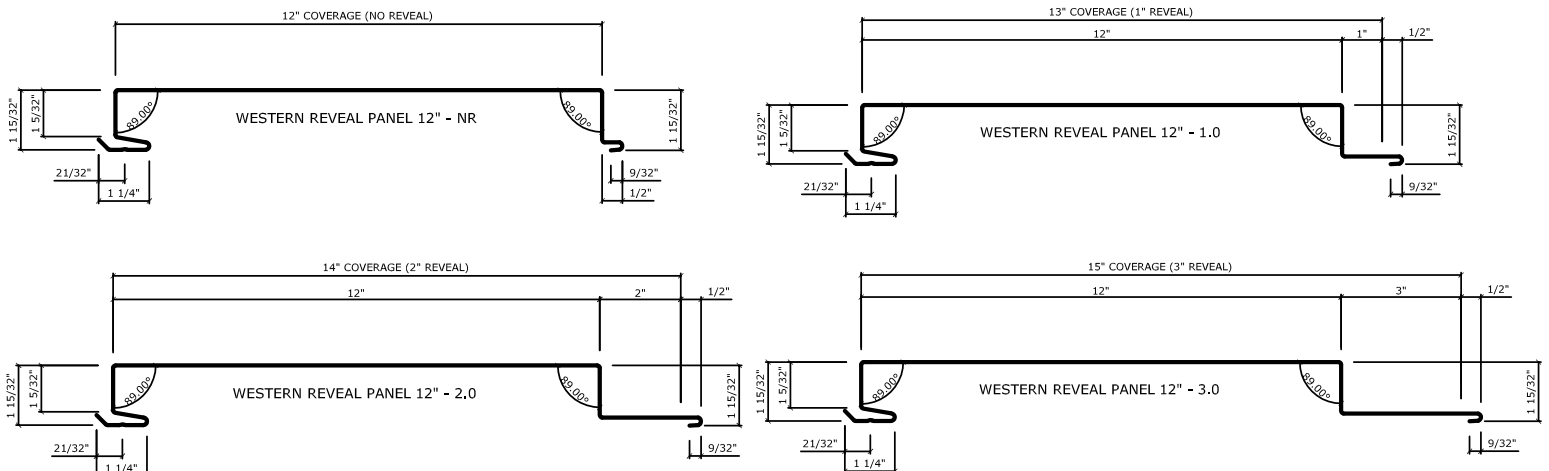

Colors represented on this profile sheet may not match actual material. All colors should be verified using an actual metal color sample.

03.27.25

Phoenix: ☎ (602) 495-0048 ✉ sales@westernstatesmetalroofing.com | Washington: ☎ (509) 418-2833 ✉ washington-wsmr@westernstatesmetalroofing.com

Tucson: ☎ (520) 574-4247 ✉ tucsonsales@westernstatesmetalroofing.com | Texas: ☎ (972) 843-4343 ✉ texas-sales@westernstatesmetalroofing.com



Finishes You've Never Seen Before®

WESTERN REVEAL® FLUSH REVEAL PANEL - 14" FACE SIZE

For Metal Wall Panels, Fascia, Soffit, and Ceiling Panels

Available Materials: Aluminum, Copper, Corten/A606-4, Steel

Available Finishes: Bare Steel, Galvalume®/Zincalume®, Galvanized, PVDF, SMP Painted

SPECIFICATIONS:

Profile Type:	Western Reveal®	Coil Feed:	36", 24", 20"
Face Size:	14"	Panel Length:	1' to 35' max
Available Reveals:	<ul style="list-style-type: none"> • NR - No Reveal • 1.0 - 1" Reveal • 2.0 - 2" Reveal • 3.0 - 3" Reveal 	Substrate:	Copper
		Finish:	Copper
Available Gauges:	16 oz, 20 oz	Warranty:	Sold AS IS – No Warranty
Fastening Type:	Concealed	Stiffening Ribs or Pencil Ribs:	Available Upon Request
Rib Height:	1.5"	Single or Double Vent Strips:	Available Upon Request
Overall Coverage:	13"-19"	Installation:	Installed Over A Solid Substrate (Vertical or Horizontal)

Mix and match different reveals, face sizes, and widths.

APPLIES TO THE FOLLOWING COLORS/FINISHES:

- Copper

***Material does not arrive pre-weathered. Copper panels will develop a natural patina over time with exposure to the elements. Use stainless steel screws for installation. Please refer to Copper dissimilar metals and product handling disclaimer for more information.



Shown in Copper, Reveal 2.0

PROFILE:

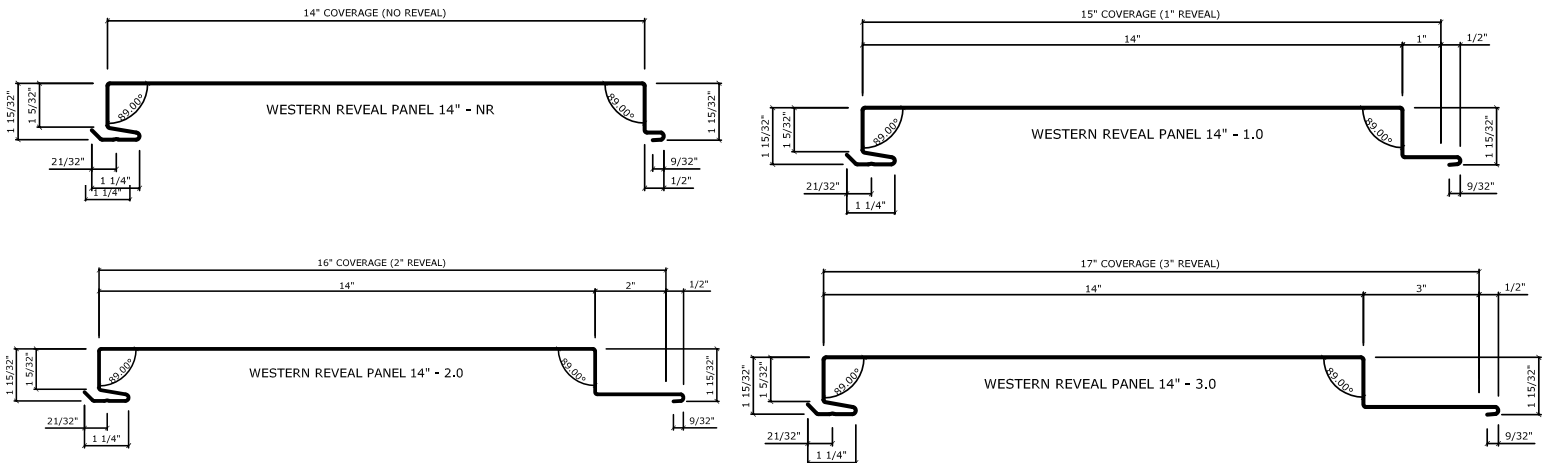

Colors represented on this profile sheet may not match actual material. All colors should be verified using an actual metal color sample.

03.27.25

Phoenix: ☎ (602) 495-0048 ✉ sales@westernstatesmetalroofing.com | Washington: ☎ (509) 418-2833 ✉ washington-wsmr@westernstatesmetalroofing.com

Tucson: ☎ (520) 574-4247 ✉ tucsonsales@westernstatesmetalroofing.com | Texas: ☎ (972) 843-4343 ✉ texas-sales@westernstatesmetalroofing.com



Finishes You've Never Seen Before®

COPPER

CORTEN FASCIA, SOFFIT,
AND WALL PANELS

WESTERN REVEAL® FLUSH REVEAL PANEL - 16" FACE SIZE

For Metal Wall Panels, Fascia, Soffit, and Ceiling Panels

Available Materials: Aluminum, Copper, Corten/A606-4, Steel

Available Finishes: Bare Steel, Galvalume®/Zincalume®, Galvanized, PVDF, SMP Painted

SPECIFICATIONS:

Profile Type:	Western Reveal®	Coil Feed:	36", 24", 20"
Face Size:	16"	Panel Length:	1' to 35' max
Available Reveals:	<ul style="list-style-type: none"> • NR - No Reveal • 1.0 - 1" Reveal • 2.0 - 2" Reveal • 3.0 - 3" Reveal 	Substrate:	Copper
		Finish:	Copper
Available Gauges:	16 oz, 20 oz	Warranty:	Sold AS IS – No Warranty
Fastening Type:	Concealed	Stiffening Ribs or Pencil Ribs:	Available Upon Request
Rib Height:	1.5"	Single or Double Vent Strips:	Available Upon Request
Overall Coverage:	13"-19"	Installation:	Installed Over A Solid Substrate (Vertical or Horizontal)

Mix and match different reveals, face sizes, and widths.

APPLIES TO THE FOLLOWING COLORS/FINISHES:

- Copper

***Material does not arrive pre-weathered. Copper panels will develop a natural patina over time with exposure to the elements. Use stainless steel screws for installation. Please refer to Copper dissimilar metals and product handling disclaimer for more information.

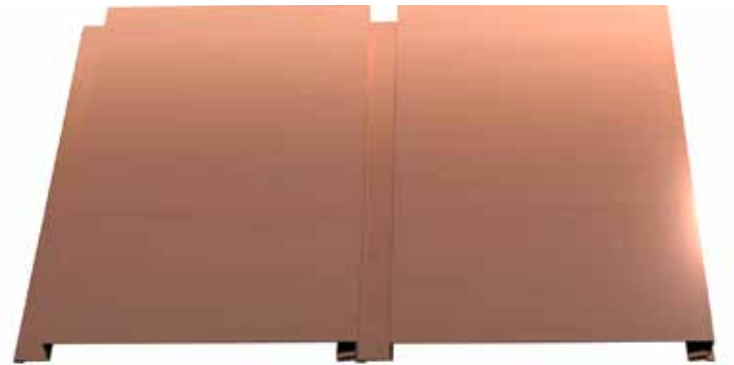

Shown in Copper, Reveal 3.0

PROFILE:

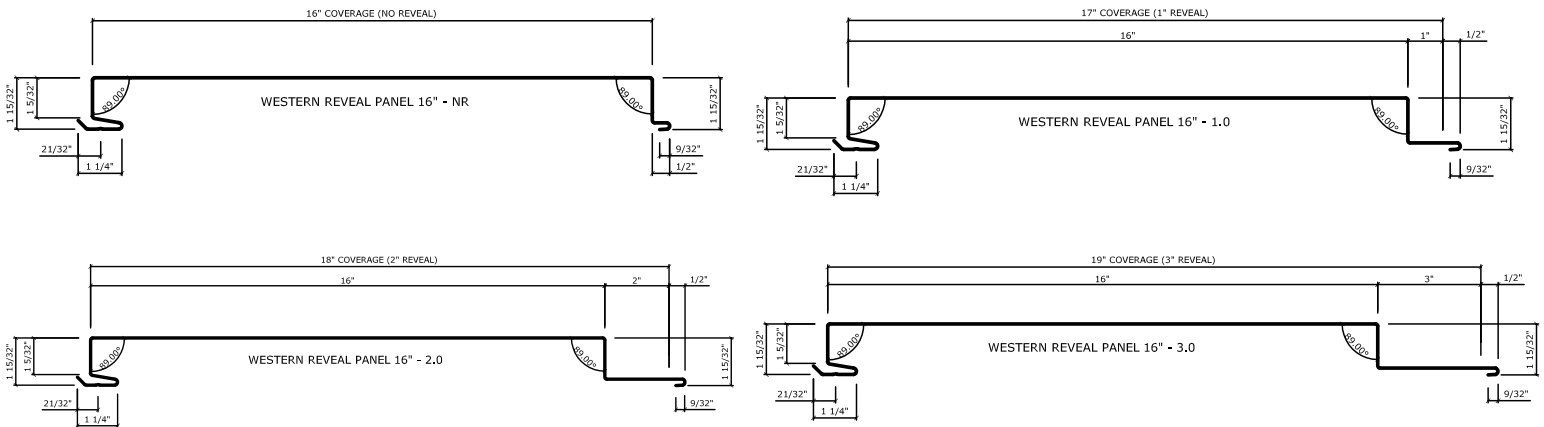

Colors represented on this profile sheet may not match actual material. All colors should be verified using an actual metal color sample.

03.27.25

Phoenix: ☎ (602) 495-0048 ✉ sales@westernstatesmetalroofing.com | Washington: ☎ (509) 418-2833 ✉ washington-wsmr@westernstatesmetalroofing.com

Tucson: ☎ (520) 574-4247 ✉ tucsonsales@westernstatesmetalroofing.com | Texas: ☎ (972) 843-4343 ✉ texas-sales@westernstatesmetalroofing.com



Finishes You've Never Seen Before®

COPPER

CORTEN FASCIA, SOFFIT,
AND WALL PANELS

WESTERN REVEAL® FLUSH REVEAL PANEL - 18" FACE SIZE

For Metal Wall Panels, Fascia, Soffit, and Ceiling Panels

Available Materials: Aluminum, Copper, Corten/A606-4, Steel

Available Finishes: Bare Steel, Galvalume®/Zincalume®, Galvanized, PVDF, SMP Painted

SPECIFICATIONS:

Profile Type:	Western Reveal®	Coil Feed:	36", 24", 20"
Face Size:	18"	Panel Length:	1' to 35' max
Available Reveals:	<ul style="list-style-type: none"> • NR - No Reveal • 1.0 - 1" Reveal • 2.0 - 2" Reveal • 3.0 - 3" Reveal 	Substrate:	Copper
		Finish:	Copper
Available Gauges:	16 oz, 20 oz	Warranty:	Sold AS IS – No Warranty
Fastening Type:	Concealed	Stiffening Ribs or Pencil Ribs:	Available Upon Request
Rib Height:	1.5"	Single or Double Vent Strips:	Available Upon Request
Overall Coverage:	13"-19"	Installation:	Installed Over A Solid Substrate (Vertical or Horizontal)

Mix and match different reveals, face sizes, and widths.

APPLIES TO THE FOLLOWING COLORS/FINISHES:

- Copper

***Material does not arrive pre-weathered. Copper panels will develop a natural patina over time with exposure to the elements. Use stainless steel screws for installation. Please refer to Copper dissimilar metals and product handling disclaimer for more information.

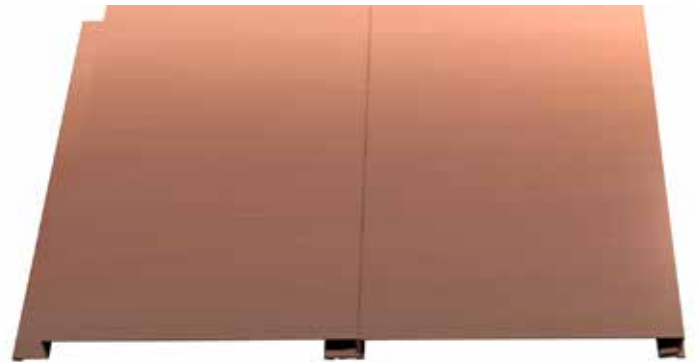

Shown in Copper, Reveal NR

PROFILE:

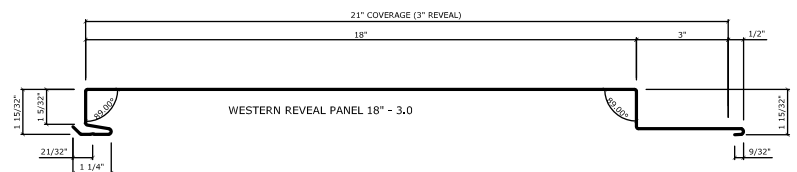
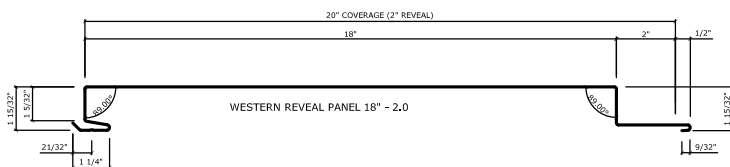
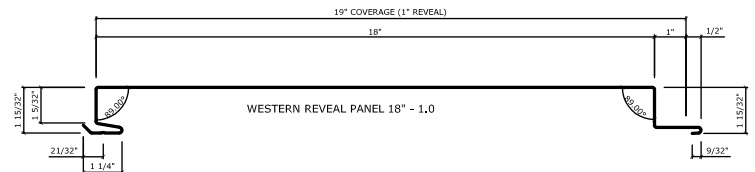
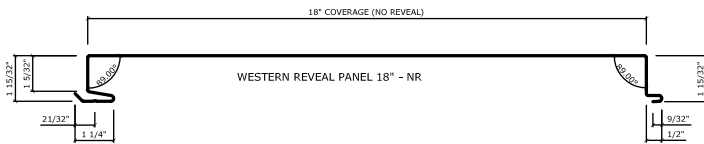

Colors represented on this profile sheet may not match actual material. All colors should be verified using an actual metal color sample.

03.27.25

Phoenix: ☎ (602) 495-0048 ✉ sales@westernstatesmetalroofing.com | Washington: ☎ (509) 418-2833 ✉ washington-wsmr@westernstatesmetalroofing.com

Tucson: ☎ (520) 574-4247 ✉ tucsonsales@westernstatesmetalroofing.com | Texas: ☎ (972) 843-4343 ✉ texas-sales@westernstatesmetalroofing.com